

POOL TECHNOLOGY CONTROL SYSTEM

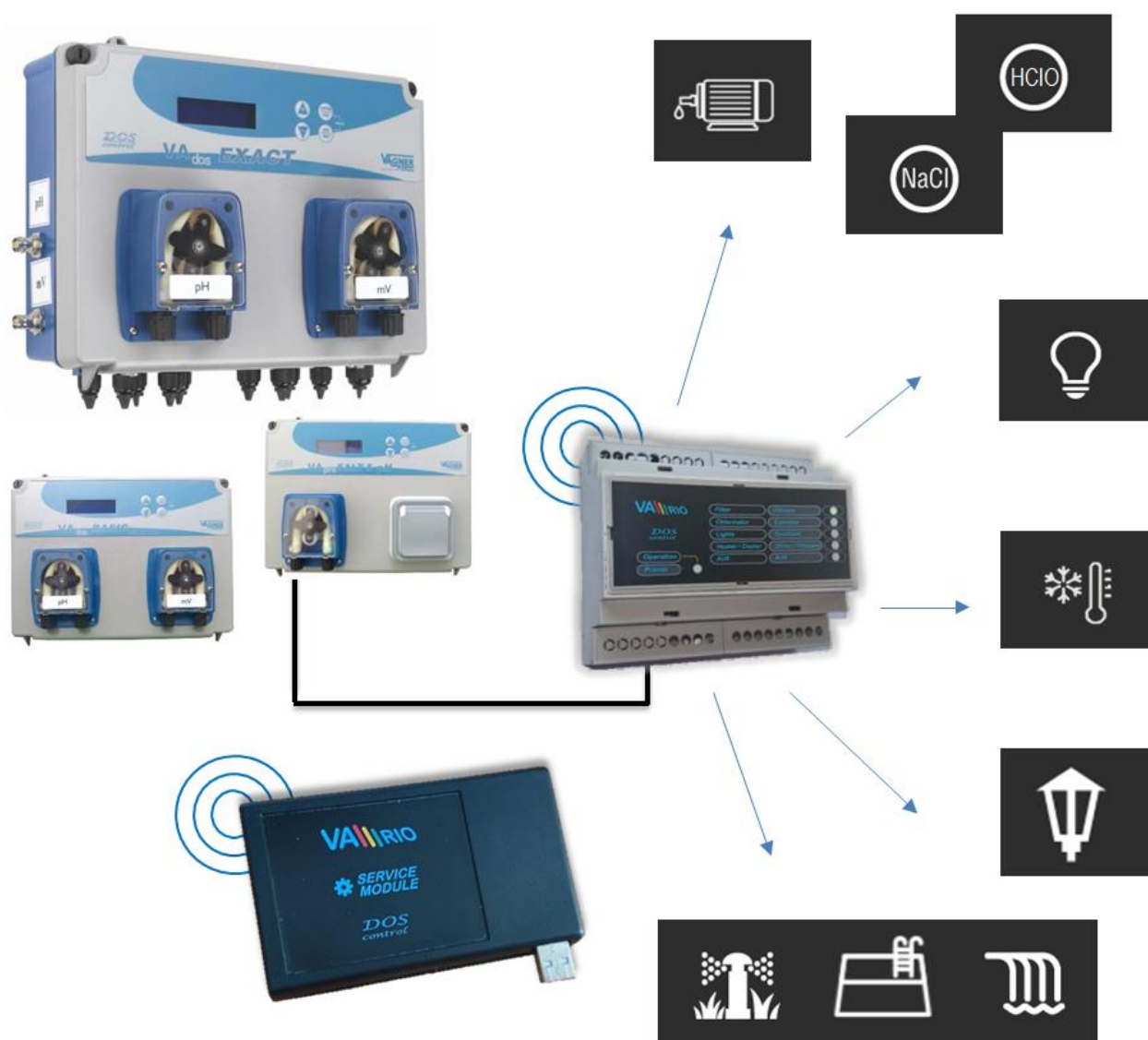

--- service module ---



1. Safety instructions



Read this user manual before installation and unit activation. Should you need any explanation or should you have any doubts, do not hesitate to contact Your VArio supplier.



The unit shall be always installed by a trained professional. Always disconnect the main power supply before performing repairs or maintenance, or before connecting additional external devices.



The system uses radio-frequency communication. It is forbidden to use the device near mines / quarries or any places with possible risk of explosion.

2. General information

Service Module is a Plug&Play device that enables an authorized person to set/modify operating parameters of the DIN module and download / backup operation data from internal memory. The service module is connected to a PC via USB and uses radio to communicate with the DIN module.

Service module - functions

- edit the security code (necessary for time and date settings in DIN module)
- set max. operation temperature
- set max. operation time in manual mode [ON] or shock chlorination [XXCL]
- set the delay for heating/cooling relay output
- adjust the strength of radiofrequency signal
- select the operation mode for R2 relay (Dosing mode / Attraction2 mode)

3. Technical information

Service module

Dimensions (w – h – d)	110 x 66 x 27 mm
Material	polystyrene
Power supply	USB 5V / 300mA
Frequency / Band	869,530 / P, max. output ≤ 20mW



4. Installation and PC connection

The service module must be connected to the PC via the USB 2.0 interface. 3.0. The operating system should automatically recognize the USB interface or install required drivers automatically. The operating system creates a COM communication port. This port must be then selected in the program VA RIO USB for proper operation of the Service and DIN module.



The VArio Service Program together with the USB drivers can be downloaded here: <https://www.variopools.com/download/>

- 1) Connect the Service module via USB interface to PC.

The operation system automatically assigns a COM port to the used USB port

Here you can check/find the assigned COM port:

This computer / Computer Management / Device Manager / Ports (COM and LPT)

(in this case **COM5**)

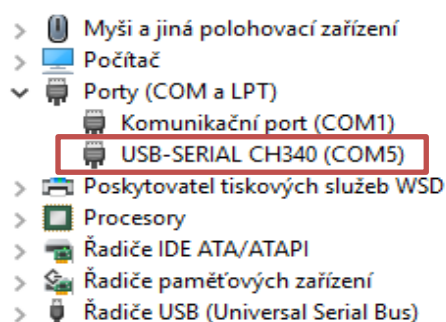

2) Open the Vario Service program

DIN module connection, memory reading, time synchronization

- A.** Choose the right communication port as described above (in this case COM5),
- B.** Enter the SN of the DIN module (the SN is on the back side of the module),
- C.** Click the “**Connect**” button to pair your service module with the DIN module,
- D.** Save the data from internal EEPROM memory of the DIN module using the “**Save**” button (export takes approx. 5 min and will be saved in an automatically created folder: C:\Vario\snXXXX\),
- E.** Synchronize date and time settings of the DIN module with the “**Synchronize**” button,
- F.** Import the operation settings of the DIN module using the “**Load from DIN**” button,
- G.** Save and send your settings to the DIN module with the “**Send to DIN**” button.

VarioServis11

Vario Servis 11 EN

Communication port **A** COM4

B DN 18MO110022 **C** Connect

Download EEPROM data **D** Download

DIN module settings

Time and date **E** Synchronize

Parameters **F** Import from DIN **G** Export to DIN

Password (0000 - 9999) 1234

Max. temperature (15-38°C) 35

Filtration MAN/xxCL (2-30h) 24

Heating delay (2-15min) 5

RF power(1-7) 5

R2-Relay configuration Dossing

Backwash duration (2-5min) 3

☐ Local VarioWiFi Password reset

DNXXXXXXXXXX

Sériové číslo na štítku na boční straně DIN modulu

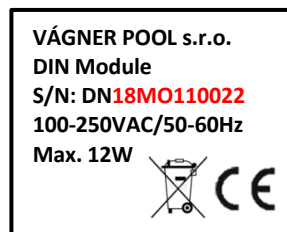

DNXXXXXXXXXX

Sériové číslo na mikročipu



VarioServis11

Vario Servis 11

EN

Communication port: COM4

DN: 18MO110022

Connect

Download EEPROM data

Download

DIN module settings

Time and date

Synchronize

Parameters

Import from DIN

Export to DIN

1 Password (0000 - 9999) 1234

2 Max. temperature (15-38°C) 35

3 Filtration MAN/xxCL (2-30h) 24

4 Heating delay (2-15min) 5

5 RF power(1-7) 5

6 R2-Relay configuration Dosing

7 Backwash duration (2-5min) 3

8 ☐ Local VarioWiFi Password reset

1 - Password

set the verification code (necessary to save date and time settings/DIN module)
(default password 1234)

2 - Max. temp

set the max. operation temperature of the pool heating system
(this case max. adjustable temp. 32°C)

3 - Max. filtration time

set the maximum operation time for the manual mode [ON] or the shock chlorination mode [XXCL]
(this case time ON – 10/10-CL hours)

4 - Heating delay

set the delay in mins for the heating/cooling relay output
(this case 2 minutes delay)

5 - RF power – adjust the strength of the radiofrequency signal
(Recommended value = 5)

6 - Konfigurace relé R2/R2 relay configuration – select an operation mode for the R2 relay:
R2 = Dosing (timed control)
R2 = Attracion2 (timer)

7 Flush time – for active dosing or heating, an additional time period can be preset to flush the pipes clean of chemicals or hot water after the filtration cycle shut-off

VÁGNER POOL s.r.o.
WiFi Module
S/N: WF19MO110023
Web: mYPH-fw01-jgCW
100-250VAC/50-60Hz



8 Reset local VarioWiFi password – should the customer need to reset the password for local WiFi mode (eg. forgotten password), it can be reset to factory default value using this button.

(SSID: WiFi Module Serial Number (e.g. WF19MO110023) / Password: VarioPool)

SN: WFxxxxxxx (Serial number on the WiFi module label – SSID for local operation mode)

Web: xxxx-xxxx-xxxx (Registration number for connecting via the Internet – www.variopools.com)

DECLARATION OF CONFORMITY

The company VÁGNER POOL s.r.o. hereby declares, that all below-listed products meet the necessary requirements for placing the product on the market:

Product line: VARIO – Pool Technology Remote Control System
Directive: RED Directive č. 2014/53/EU

Module: DIN Module

Applicable norms: EN 62368-1: 2014/A11:2017, EN 60730-1: 2016, EN 62479: 2010
EN 301 489-1 V2.1.1, EN 301 489-3 V2.1.1
EN 300 220-1 V3.1.1, EN 300 220-2 V3.2.1

Module: WiFi Module

Applicable norms: EN 62368-1: 2014/A11:2017, EN 62311: 2008
EN 301 489-1 V2.1.1, EN 301 489-3 V2.1.1, EN 301 489-17 V3.1.1
EN 300 220-1 V3.1.1, EN 300 220-2 V3.2.1, EN 300 328 V2.1.1

Module: RC Module

Applicable norms: EN 62368-1: 2014/A11:2017, EN 62479: 2010
EN 301 489-1 V2.1.1, EN 301 489-3 V2.1.1
EN 300 220-1 V3.1.1, EN 300 220-2 V3.2.1

Module: Service Module

Applicable norms: EN 62368-1: 2014/A11:2017, EN 62479: 2010
EN 301 489-1 V2.1.1, EN 301 489-3 V2.1.1
EN 300 220-1 V3.1.1, EN 300 220-2 V3.2.1

Conformity was checked by Technický skúšobný ústav Piešťany (TSÚ), which – based on test report No. 190500058/1-4 – issued Conformity Certificates to all of the above-listed modules.

Declaration Issue Date: 20. 3. 2019

Producer Stamp and Signature:

VÁGNER POOL s.r.o., Nad Slatinou 348
252 51 Věsteč Praha – západ
IČ: 27121062 DIČ: CZ27121062

PRODUCER:

VÁGNER POOL s.r.o.
Nad Safinou II 348 Vestec, Prague-west
252 50
Czech Republic
www.vagnerpool.com
info@vagnerpool.com
[+420 244 913 177](tel:+420244913177)



More information and documentation about VARIO system can be downloaded here: www.variopools.com.